

★ PHASE IV - Murfreesboro Gateway



Phase IV History & Overview

Owned by North Church, LLC this phase is part of a tract that was purchased by the C.M. Gatton Trust. When developed, this phase will accommodate office and retail frontage.

This phase is part of the Murfreesboro Gateway and is located just off of I-24 at Medical Center Parkway. It is adjacent to the new Rutherford County Chamber & Tourism facility. Across Medical Center Parkway is the Embassy Suites Hotel & Conference Center. Also across the parkway is The Avenue, a lifestyle mall of more than 130 retailers. Just to the South is Phase II, where luxury apartments are scheduled to open in 2014.

Phase IV is ideal for hospitality, low and midrise office buildings with retail frontage. Thornton's opened in 2011.

All phases of the Murfreesboro Gateway are owned by C.M. Gatton Property and developed by Tommy Smith of StoneGate Properties.

Tommy Smith
615-893-8877

tsmith@SGCDevelopment.com
www.SGCDevelopment.com



★ PHASE IV - Murfreesboro Gateway

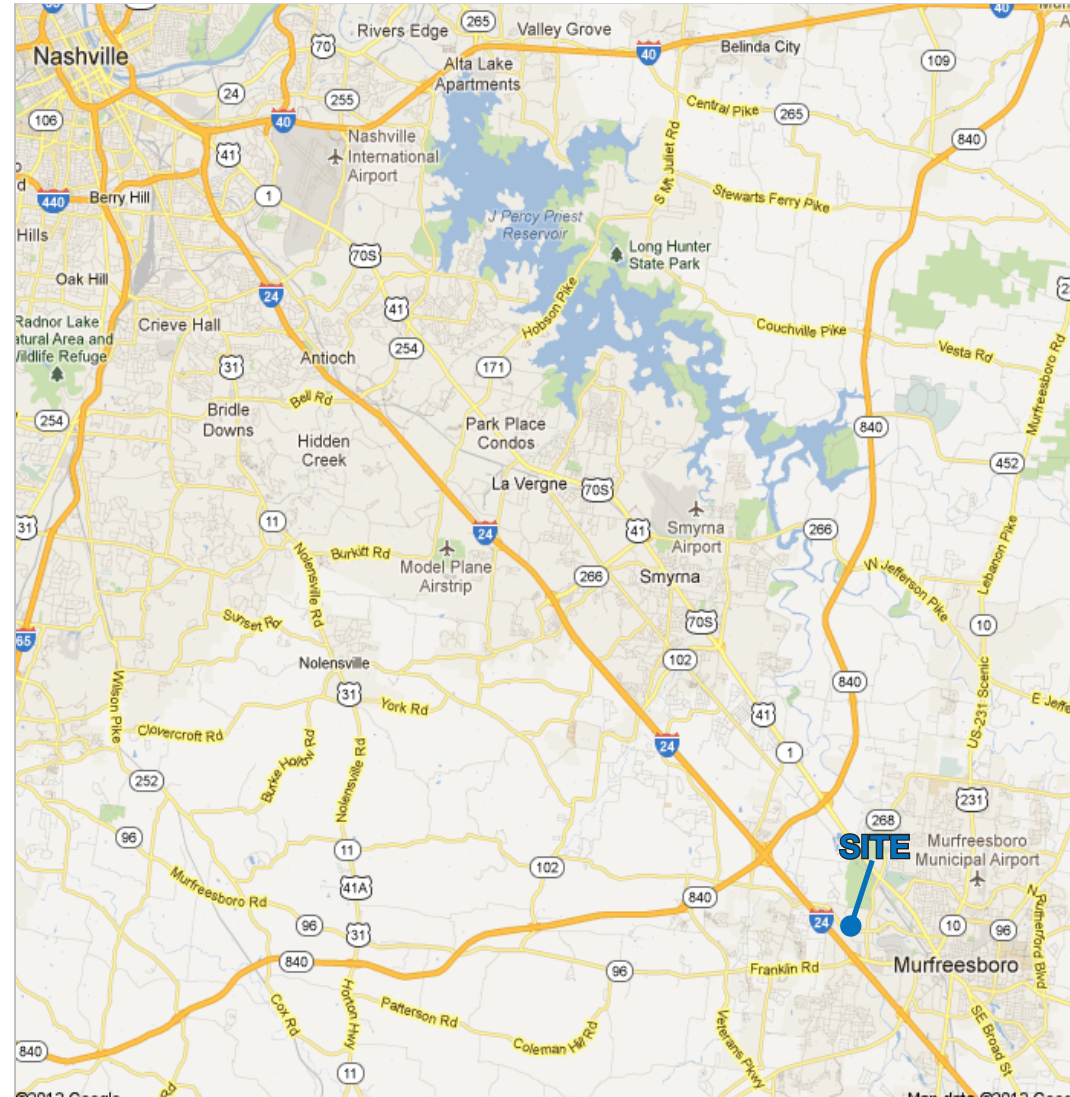
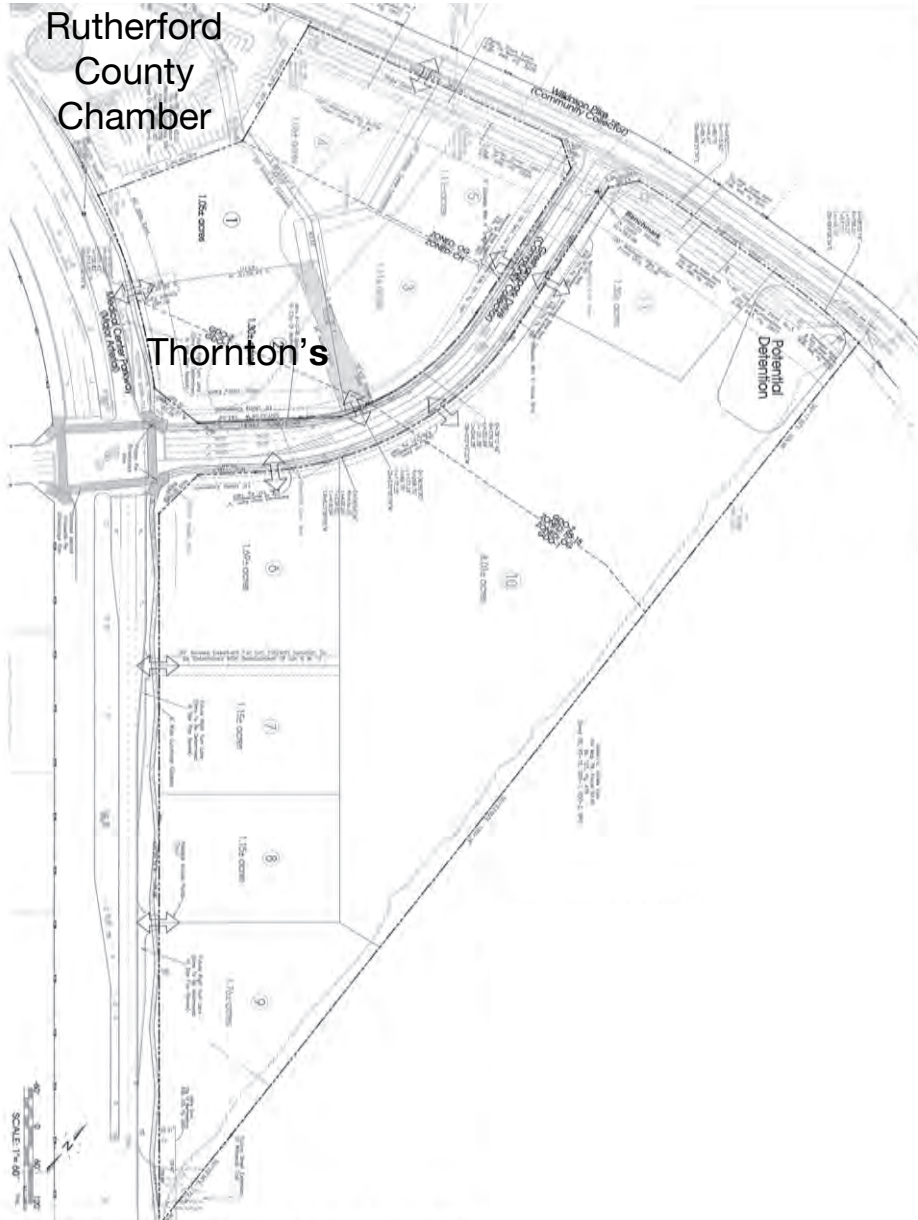

Tommy Smith
615-893-8877
tsmith@SGCDevelopment.com
www.SGCDevelopment.com

